

# Pullman Chair and Chair Pod

High-backed lounge seating for focus or collaboration.

Inviting and elegant, the Pullman Chair and Chair Pod are a flexible choice for open-plan offices, hospitality, airport lounges and educational spaces alike.



## Core Features

Available with integrated tablet arm.  
Power and data optional.  
Two-tone upholstery.  
Range of base options available.  
10-year warranty.

Designed by NaughtOne

Enquire about this product at  
[www.naughtone.com](http://www.naughtone.com)



Sizes

All dimensions quoted are rounded to the nearest 5 mm or nearest 1/2 inch

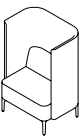

PUL15H

Pullman Chair with Legs  
w900 d675 h1300  
seat 450 (mm)  
weight 47.2 kg  
w35.5 d26.5 h51  
seat 18 (in)  
weight 104 lb

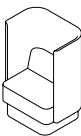

PUL15HPL

Pullman Chair with Upholstered Plinth  
w900 d675 h1300  
seat 450 (mm)  
weight 53.5 kg  
w35.5 d26.5 h51  
seat 18 (in)  
weight 118 lb

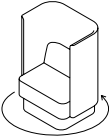

PUL15HSW

Pullman Chair with Upholstered Swivelling Plinth  
w900 d675 h1300  
seat 450 (mm)  
weight 60.1 kg  
w35.5 d26.5 h51  
seat 18 (in)  
weight 133 lb

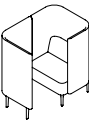

PULPHRA

Pullman Chair Pod with Legs (Screen Right)  
w900 d1300 h1300  
seat 450 (mm)  
weight 91.5 kg  
w35.5 d51 h51  
seat 18 (in)  
weight 202 lb

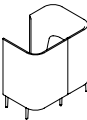

PULPHLA

Pullman Chair Pod with Legs (Screen Left)  
w900 d1300 h1300  
seat 450 (mm)  
weight 91.5 kg  
w35.5 d51 h51  
seat 18 (in)  
weight 202 lb

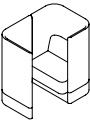

PULPHRAP

Pullman Chair Pod with Upholstered Plinth (Screen Right)  
w900 d1300 h1300  
seat 450 (mm)  
weight 92.5 kg  
w35.5 d51 h51  
seat 18 (in)  
weight 204 lb

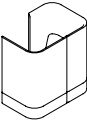

PULPHLAP

Pullman Chair Pod with Upholstered Plinth (Screen Left)  
w900 d1300 h1300  
seat 450 (mm)  
weight 92.5 kg  
w35.5 d51 h51  
seat 18 (in)  
weight 204 lb

Leg Options



Black / white steel legs



NaughtOne RAL powder coated legs



Solid oak legs



Solid walnut legs

Table Top Options



Black / white MFMDf with polished MDF edge



Oak veneer with reverse chamfer, polished MDF edge



Walnut veneer with reverse chamfer, polished MDF edge

Other Options

See price list for details

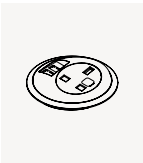

Power and data

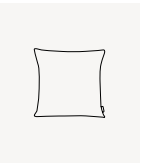

Scatter cushion



Tablet arm



Two tone

NaughtOne RAL Palette



Testing

Structural Testing Certifications

PUL15H

Pullman Chair with Legs and Tablet Arm  
BS EN 16139:2013, Level 2 Static Load 200 kg

ENTIRE COLLECTION

ANSI/BIFMA X5.4 (2020) Lounge and Public Seating  
ANSI/BIFMA X5.5 (2021) Desks and Tables  
ANSI/BIFMA X5.6 (2016) Panel Systems  
Exclusions: Tablet arms.

Flammability

The cold cure foam material has been tested to meet the following standards:

- British standard: 5852:2006 Part 2
- California Technical Bulletin: 117-2013
- Italian standard: UNI 9175-CLASS 1.1M

The flammability standard of the covering fabric is dependent on the choice made by the customer.

10 year warranty

Our decade-long warranty is proof of our commitment to robust engineering and durable design, built on our belief that long-lasting products are essential to sustainable business practice.

Product Sustainability Statement

The Pullman Chair is available in a range of sizes and finishes but for the purpose of this document we have a specific example from the range: Pullman Chair with steel legs and tablet arm.

All figures use UK-based industrial manufacturing data. The kg CO<sub>2</sub>e calculations are based on the cradle-to-gate phases of a Life Cycle Assessment at NaughtOne's factory in Elland, UK.

Recyclable Content



Recycled Content



Material Percentage Split

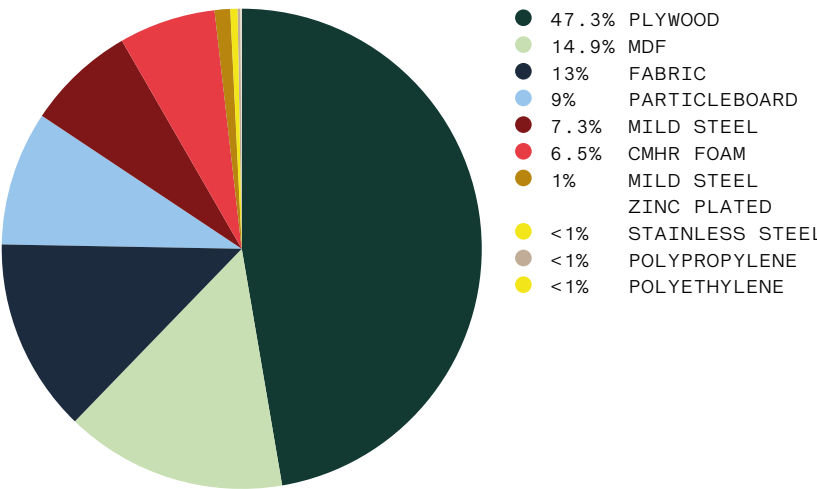

Environmental Attributes

- NaughtOne is FISP and ISO14001 certified
- FSC® certified products available upon request (FSC® C134222)
- 42.7 kg total weight
- 15.7% Recyclable (foam, fixings, legs, brackets and plastic fixtures)
- 71.3% Reusable (frame, table top)
- 23.2% Recycled content (foam, fixings, legs, brackets, plastic fixtures and table top)
- SCS Indoor Advantage™ Gold ANSI / BIFMA Furniture Emissions Standard (M7.1 / X7.1-2011 R2021) and ANSI / BIFMA e-3-2019 (Credits 7.6.1, 7.6.2, 7.6.3)

These attributes can help you to achieve criteria towards LEED, BREEAM, Ska and WELL building certifications.

Life Cycle Assessment

